

# LMH RESIDENT APP

*Participant Guide*



**LMH**

Manage your apartment home  
information and services with a few  
simple touches.

**Sign Up**

I already have an account. **Sign In**

## HOW TO REGISTER

Follow the steps below to register into the Liberty Resident App once it's been downloaded from the Apple Store or Google Play Store.

- 1** Tap the **Sign Up** option to register.

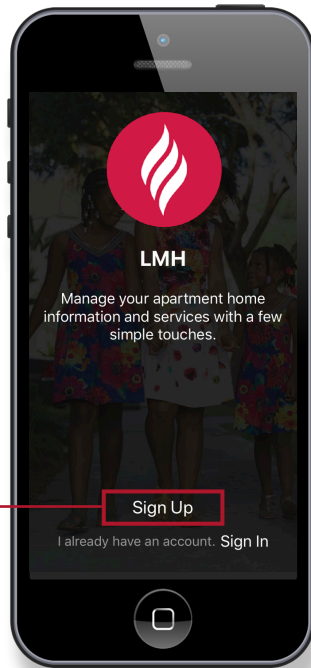

- 2** Enter the **city or name** of your community then **Tap Search**. A list of community names will appear.

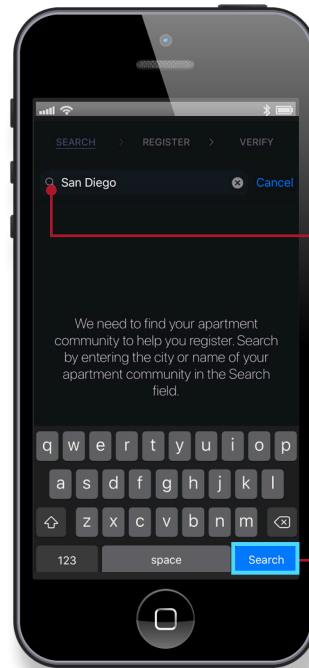

Tap your **community**.

- 3** Enter the **Primary email address** that is on file with your community.

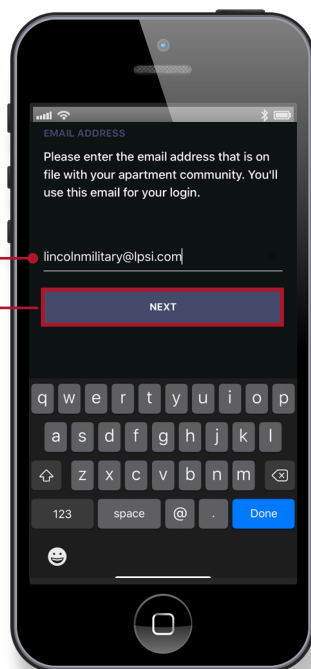

- 4** Tap **Next**.

- 5** Enter the **following**:

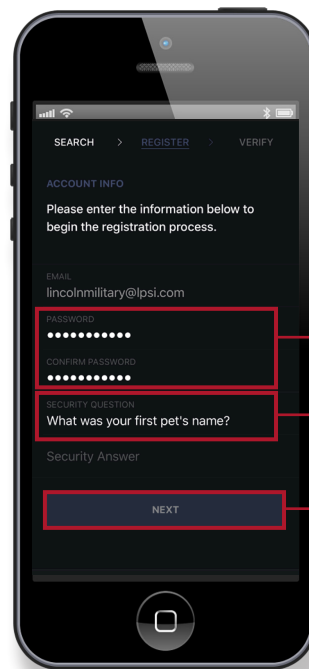

**Create and confirm** your **password**.

**Enter your security answer.**

Tap **Next**.

## HOW TO REGISTER *con't*

Follow the steps below to register into the Liberty Resident App once it's been downloaded from the Apple Store or Google Play Store.

- 6** Tap **one** of the **two options** to begin the **verification process**.

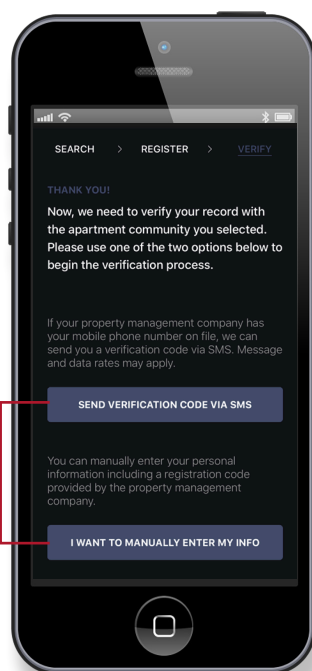

- 7** Enter the following:

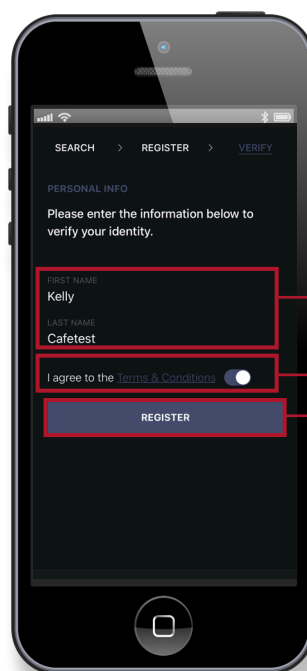

First & Last Name

Slide right to agree to the Terms & Conditions

Tap Register

- 8** Tap **DONE** to complete the **registration process**.

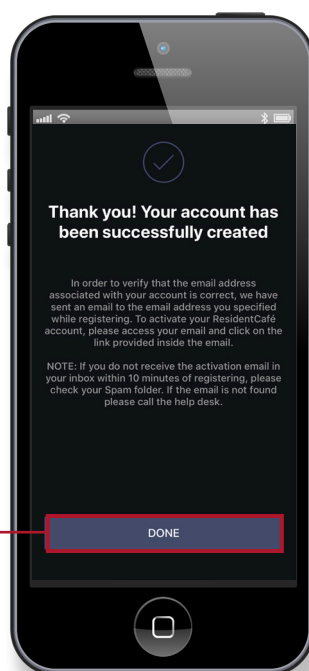

## SIGN IN TO RESIDENT APP

Follow the steps below to submit a maintenance request.

- 1** Enter your **email address** and **password**.

**NOTE:**

Slide the “Remember me” to the right for the app to remember your login information.

- 2** Tap **Sign In**.

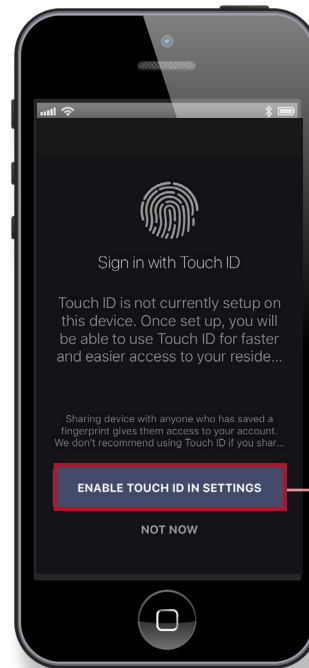
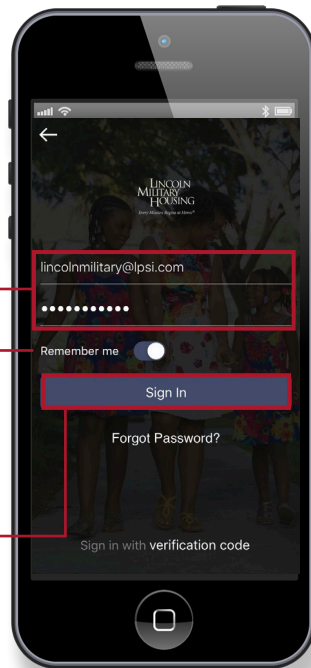

**NOTE:**

You will have the option of setting up the “Sign in with Touch ID”.

**Maintenance -**

Allows our residents to easily submit a maintenance request, attach photos, voice memos, and track the progress.

**Events -**

Residents will be able to see upcoming monthly and weekly events taking place within their community.

**Announcements -**

Residents will have access to view community announcements.

**Contact Us -** directly calls our Liberty At Your Service at **(888)578-4141**

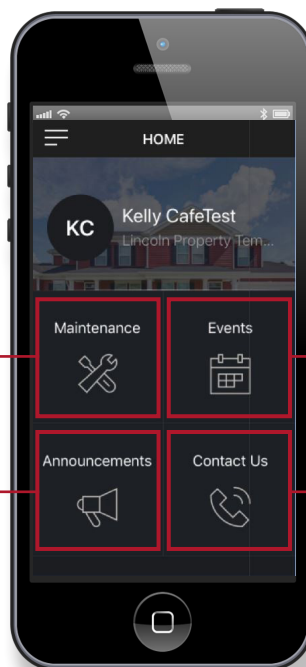

# SUBMITTING A MAINTENANCE REQUEST

Follow the steps below to submit a maintenance request.

- 1 Tap the **Maintenance** option.

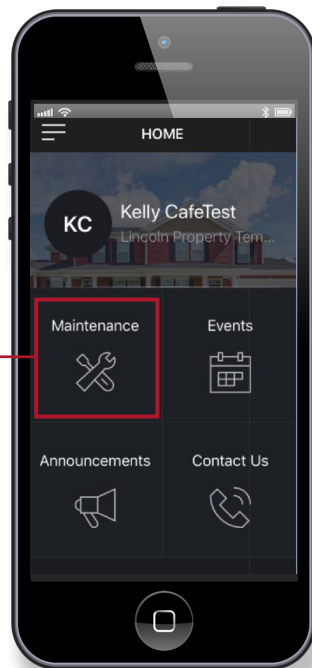

- 2 Tap **+** option to create a **new maintenance request**.

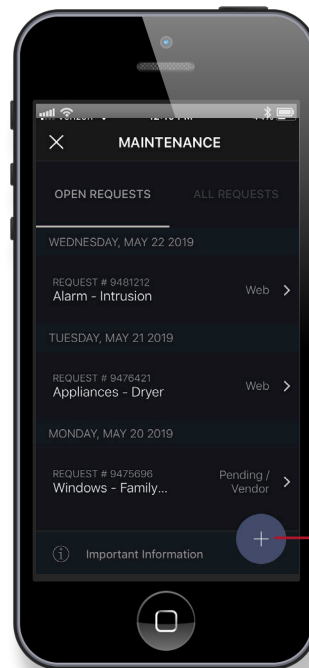

**NOTE:**  
The new request screen will appear.

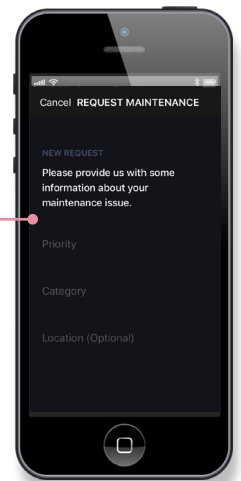

- 3 Tap **PRIORITY** to select whether the service is an  
**03-Routine**  
**02-Urgent**  
**01-Emergency**

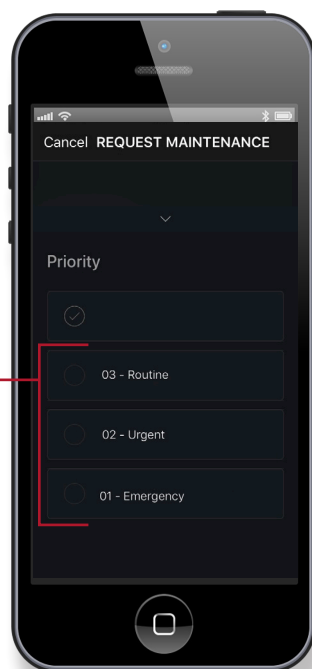

**NOTE:**  
If resident is experiencing an **Emergency** in their home that requires immediate attention, we encourage them to **call** Liberty At Your Service at **(888)578-4141 24/7**

- 4 Tap **CATEGORY** and **scroll up or down** to select the category for the **maintenance request**.

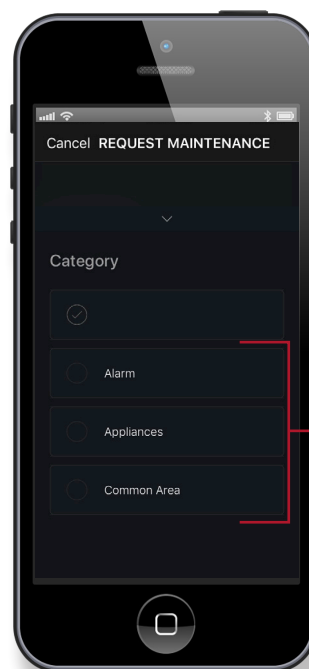



## SUBMITTING A MAINTENANCE REQUEST *con't*

Follow the steps below to submit a maintenance request.

- 5 Tap **SUBCATEGORY** and **LOCATION** and **scroll up or down** to select the **subcategory** and **location** of the maintenance request.

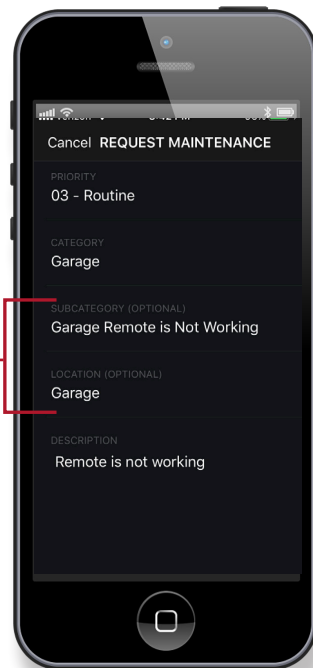

- 6 Include a **DESCRIPTION** of the maintenance request.

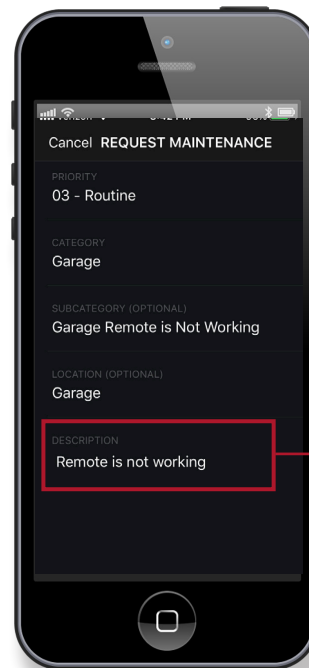

- 7 Tap **ADD PHOTO** (optional) to include a photo on the maintenance request.

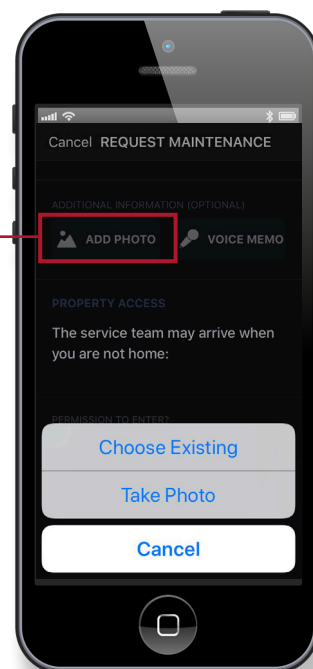

- 8 Tap the **VOICE MEMO** (optional) to include a voice memo on the maintenance request.

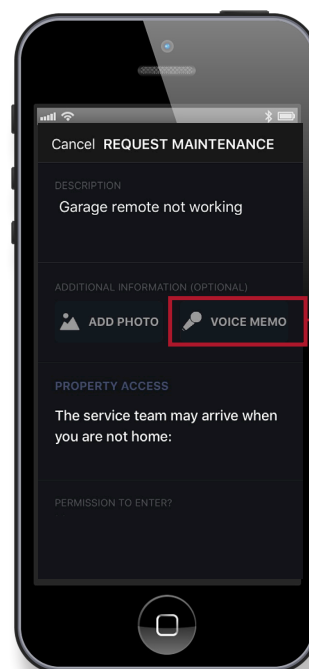

## SUBMITTING A MAINTENANCE REQUEST *con't*

Follow the steps below to submit a maintenance request.

**9** Tap the **Permission to Enter** to grant permission to a service technician to enter your home to work on the maintenance request if you are not home.

**10** Tap the **SUBMIT REQUEST** to complete the maintenance request.

**11** Tap on **DONE** after viewing message.

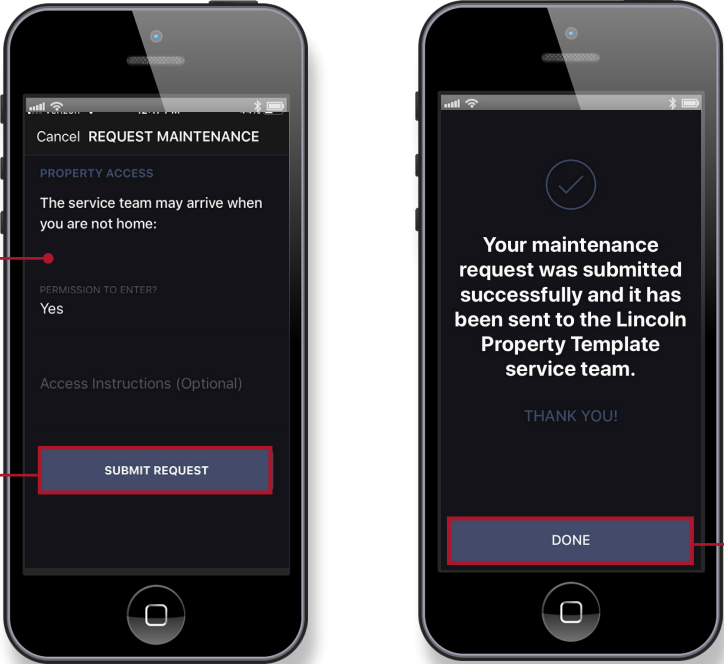

## TRACKING A MAINTENANCE REQUEST

The **OPEN REQUESTS** section will display and **track all pending maintenance requests**.

The **ALL REQUESTS** will display history of all **maintenance requests**.

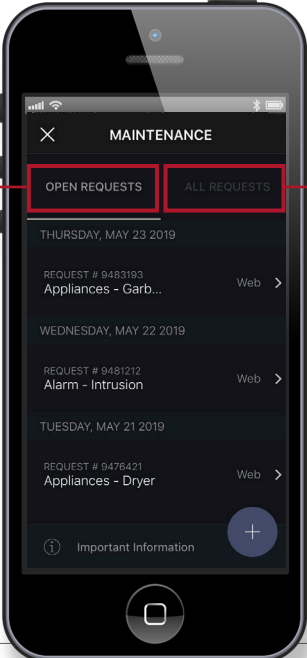

## FREQUENTLY ASKED QUESTIONS

**Q** Can the residents register within the Liberty Military Resident App?

**A** While registration is available via the app, we recommend encouraging our residents to register within the resident portal located within our Liberty Military Website using their computer and or laptop.

**Q** What kind of priorities can residents select when creating a Maintenance Request?

**A** They can select Emergency, Urgent, and or Routine. If residents have Emergencies, please encourage them to call Liberty At Your Service.

**Q** Does the below error message impact residents ability to create and submit a maintenance request

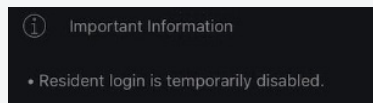

**A** If and when residents see the above message, “Resident Login is temporarily disabled,” assure them that is a behind-the-scenes message that will not impede them from creating and submitting their maintenance requests.

**Q** Where do the attachments go from the App?

**A** Within the WO, the Function drop-down at the top will show Attachments option. This section will have images and voice memos recorded from the App.

Work Order #9490070		Functions ▾
Status	Web	<div>Attachments (2)</div> <div>Memo</div> <div>Contact</div>
Reason		
Property	<a href="#">propxxxx</a>	
	Vendor	Expense Type

**Q** How can Liberty Team members update the resident via the App?

**A** Within Voyager, Liberty Team members can add dates/notes to the Access Entry notes. IT recommends adding date time and note. **NEVER** overwrite previous entries.  
 Example:  
 5/28 10:10AM Inspected appliance. Ordered part. Will reschedule install when part arrives.  
 5/29 1:15PM Part arrived, will be scheduling to install.

**Q** Can residents register for events in the event section of our App?

**A** No, our community services events portal is staying the same.  
 Our residents can go to [libertymilitaryresident.com](http://libertymilitaryresident.com) for event registrations.



## This image shows a full page of blank, lined paper. It features approximately 20 evenly spaced horizontal grey lines across its entire width, providing a template for writing or drawing. The margins are consistent on all sides.

